

FSLSM – 60" Tall Free Standing Low Side Merchandiser – Slatwall

\$915.00–\$1,065.00

The FSLSM is a 60" tall Free Standing Low-Height Arch-Side Fixture. This slatwall display fixture is perfect for presenting products that hang or are best displayed in baskets. Choose widths that fit your layout. Add 1½" to "Interior Width" for full width of display.



Height 60" x

Interior Width 36" ▾

Accessories

Package A (Included) ▾

Color

5th Ave Elm 7966K-12 ▾

Clear

\$915.00

1

ADD TO QUOTE

SKU: FSLSM-3660-S-PKG_A Categories: [Coffee](#), [Snack Racks](#), & [Kiosk Cabinets](#), [Point Of Sale Cabinets](#), [Snack Racks](#), [Free Standing Fixtures](#), [60" and shorter Free Standing Fixtures](#)

Description

Additional Information

Product Description

60" Tall Free Standing Merchandiser Series

The FSLSM, a 60" tall free standing merchandiser, provides product display space without blocking line-of-sight in your cafe or micro-market. The FSLSM fixture adds beautiful curves to any space. This fixture **ships fully assembled**. Choose from standard sizes or ask a sales representative about custom sizes. The FSLSM ships fully assembled. The cabinet ships with Hardware Package A. Ask about options at time of order.

High Quality Construction

This stand alone fixture is constructed of engineered particleboard and high pressure laminate and built complete with ¾" arched side walls, slatwall main wall and 12" base cabinet. The 60" tall arched sides give the appearance of built-in permanence, however this free

standing merchandiser fixture stands on it's own. There are three different Accessory packages available. Specify the desired basket or shelving package from the drop down menu above or at time of order. Ask about the optional finished outside back panel, custom color combinations, special sizes and more. Our free standing merchandiser line is designed to be set in place, loaded with product and ready for the operation of your Micro-Market to start.

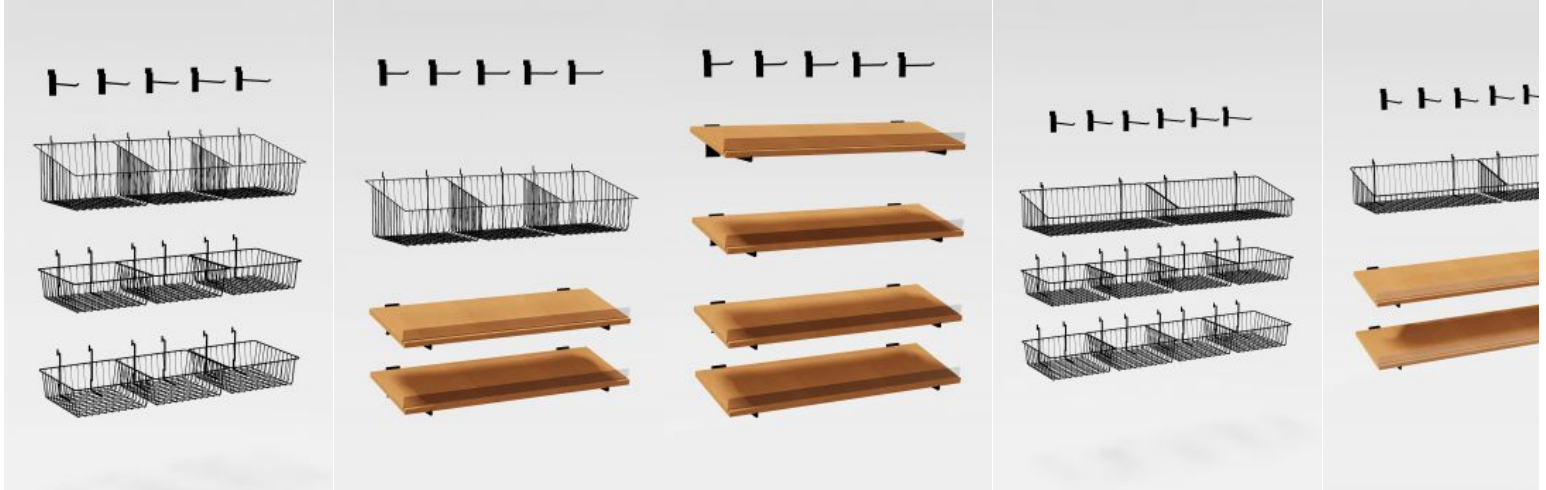

Hardware Accessory Packages for Free Standing Merchandiser Fixture Details

Hardware Accessory Package A consists of wire baskets and hooks while Package B includes two full width shelves with clear product stops along with wire baskets and hooks. Most noteworthy Package C includes four full width shelves and wire hooks.

Display Shelving / Baskets for 36" to 42" Models

PKG A3642-60:(5) 8" Hooks, (3) 12"w x 12"d x 8"back x 4"front Sloping Wire Baskets, (6) 12"w x 12"d x 4"h Wire Baskets

PKG B3642-60:(5) 8" Hooks, (3) 12"w x 12"d x 8"back x 4"front Sloping Wire Baskets, (2) Millwork Shelves with Acrylic Product Stops

PKG C3642-60:(5) 8" Hooks, (4) Millwork Shelves with Acrylic Product Stops

Display Shelving / Baskets for 48"

PKG A48-60:(6) 8" Hooks, (2) 24"w x 12"d x 6" back x 2" front Sloping Wire Baskets, (8) 12"w x 12"d x 4"h Wire Baskets

PKG B48-60:(6) 8" Hooks, (2) 24"w x 12"d x 6" back x 2" front Sloping Wire Baskets, (2) Millwork Shelves with Acrylic Product Stops

PKG C48-60:(6) 8" Hooks, (4) Millwork Shelves with Acrylic Product Stops

Tier 1 - In Stock Colors

Faster production for faster delivery!



Tier 2 - Colors

A little bit longer lead time - Same great price!



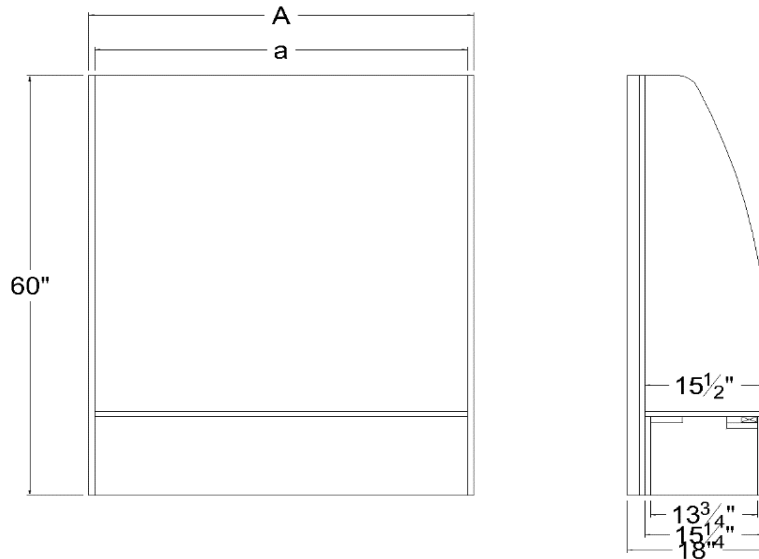

- Model numbers associate with the interior dimension of each FSLSM model.

- Shorter 60" tall height provides clear line of sight in island configurations

- Furniture Glides are installed in base corner blocking. Each glide (foot) has 1" amount of adjustment.

MODEL	Inside a	Overall A	Overall Height	Side Wall Depth	Overall Depth	Shelf Depth	Leveling Distance	Shelf Angle Positions*
FSLSM-3880-S	38"	39 1/2"	60"	18"	18"	11 3/4"	1"	4
FSLSM-4280-S	42"	43 1/2"	60"	18"	18"	11 3/4"	1"	4
FSLSM-4880-S	48"	49 1/2"	60"	18"	18"	11 3/4"	1"	4

STANDARD FEATURES - High Quality Construction from Wilsonart coordinated surfaces product line. Slatwall and toe kick sections are covered with HPL for durability. Sidewalls are 3/4" Melamine with matching banding on exposed edges. Sidewall bottom edges are banded with 3mm black PVC for durability.

ACCESSORY (HARDWARE) PACKAGES - Pkg A (Wire Baskets) is included and ships with this unit unless another hardware package is specified at time of order Pkg B (Millwork Shelves & Baskets) Pkg C (Millwork Shelves)

CUSTOM FEATURES - Customization of each FSLSM can include Artwork panel on stainless steel stand-offs located at top of slatwall section, custom color selection.

*Adjustable angled shelf brackets with chrome finish are included with hardware packages B and C. There are 2 brackets per shelf. Adjustable angle options are 0°, 15°, 30°, 45°. If black finish only available on 0° brackets.